



Campus Open House-Welcome

April 13, 2023

Construction and Planning Updates

Matt Dulcich

Director, Facilities Planning, UC Davis Health

Laura Niznik Williams, Director, Government and Community Relations

Meeting Agenda

- Welcome and Overview
- Campus Master Plan
- Current and Upcoming Projects
- Questions and Answers



Historic Photos



Historic Photos



Historic Photos



Historic Photos



Historic Photos



Historic Photos



Historic Photos



Historic Photos



Historic Photos



UC Davis Heath – Sacramento Campus: 2022

The 140-acre Sacramento campus is comprised of 3.6M GSF of buildings today.



2030 Campus Site Plan - Strategic Project Index

Over the next decade, numerous strategic projects in design or construction will transform our Sacramento campus adding over 3M GSF or new buildings

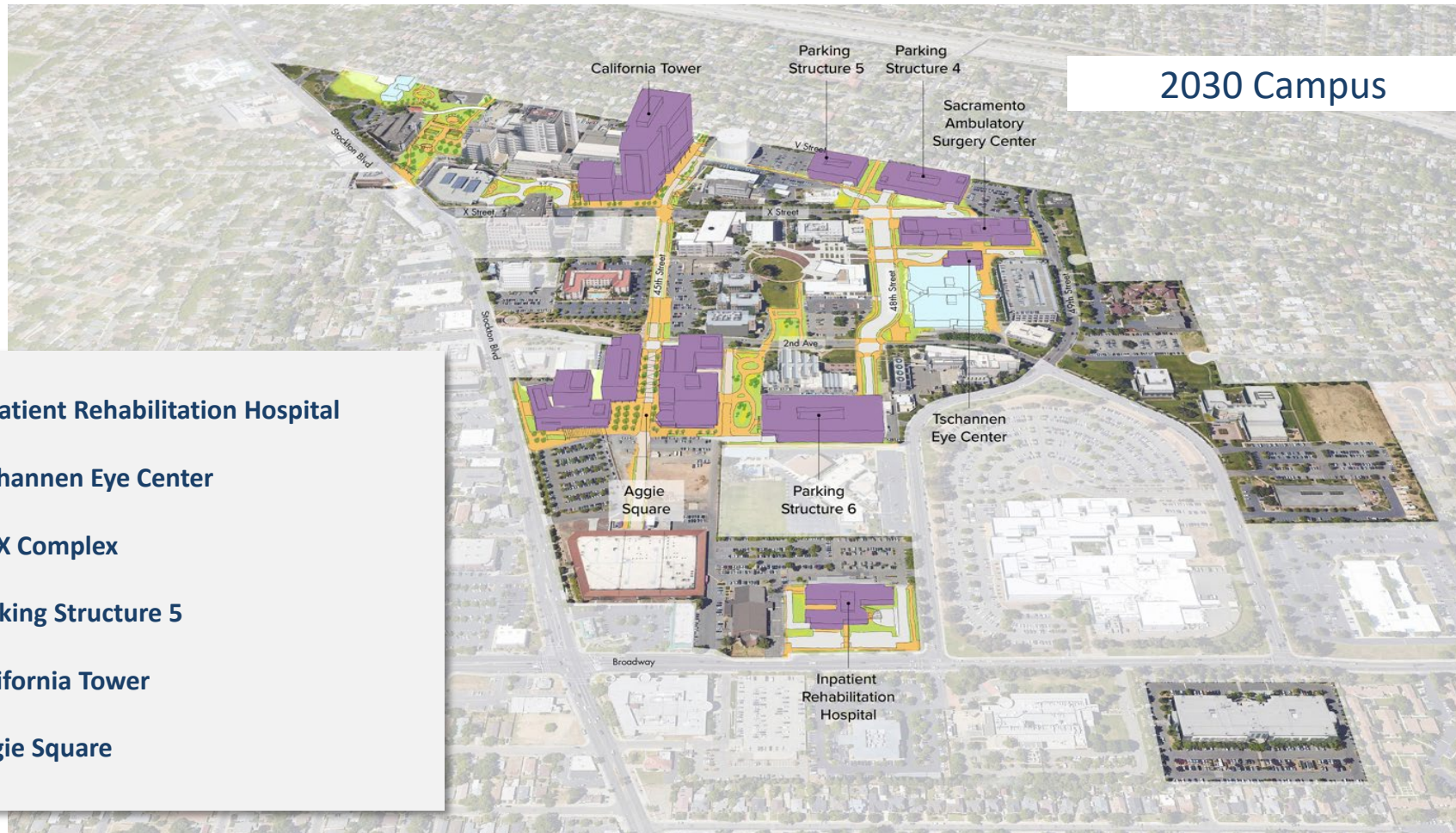

2030 Campus

- 1 – Inpatient Rehabilitation Hospital
- 2 – Tschannen Eye Center
- 3 – 48 X Complex
- 4 – Parking Structure 5
- 5 – California Tower
- 6 – Aggie Square

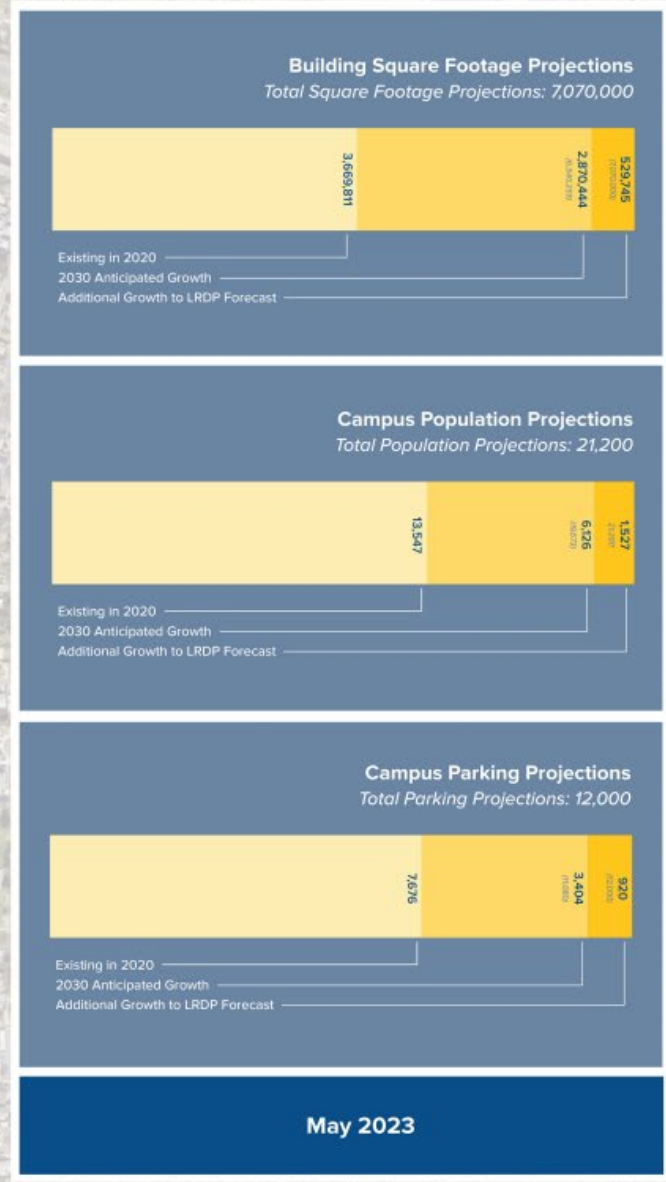
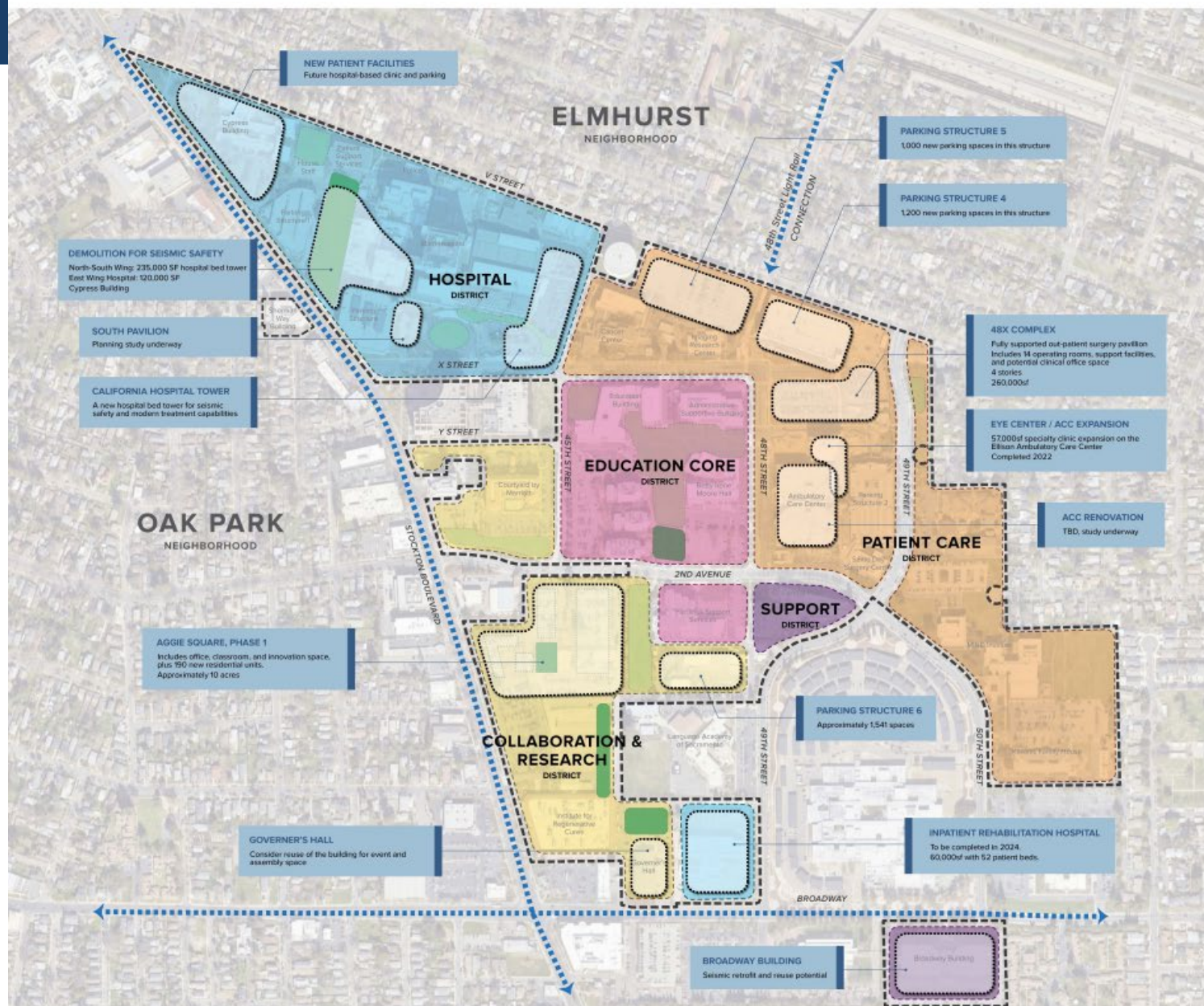

Campus Master Plan

Currently developing a 20-year campus master plan to provide a facility and infrastructure development strategy at our Sacramento campus development over the next two decades



Rehabilitation Hospital

2022 to 2030

The Rehabilitation Hospital is a Joint Venture (JV) between UC Davis Health and Kindred Hospitals. Project includes 52 inpatient rehab rooms and associated support spaces.

- 60,000+ GSF
- 52 Beds
- Anticipated First Patient: May 2023



Tschannen Eye Institute

2022 to 2030

The new Tschannen Eye Institute is an expansion of the existing ACC Building which includes 17,000 SF of renovation and a 4-story, 64,000 SF addition.

- \$91M total project cost (\$59M design and construction costs)
- Completed December 2022

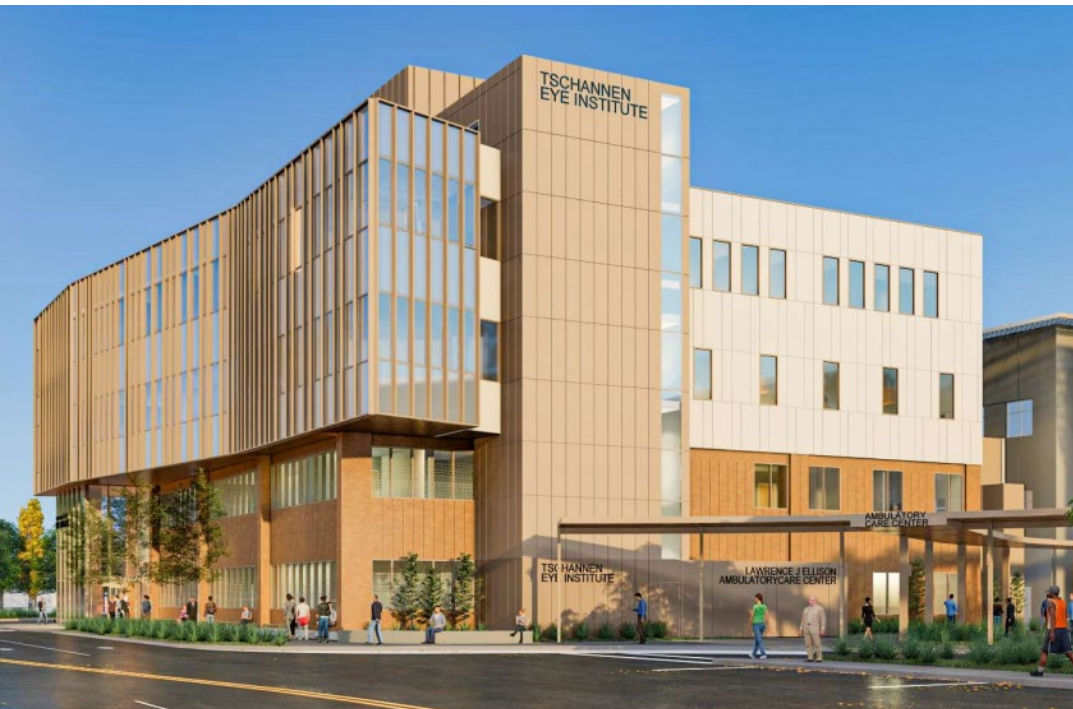

48X Surgical Complex

The 48X Complex is a new outpatient (ambulatory) 12 OR, 58 Pre-Post Recovery Bay, and 14 overnight stay room center including 100,000 SF of clinic space.

- \$563M total project cost (\$392M design and construction costs)
- Approximately 260,000 GSF in total
- Anticipated First Patient: 2025



48X Surgical Complex



48X Surgical Complex



Hospital Evolution—1928 to 2030

2022 to 2030

The current building portfolio dates back 100 years and has organically evolved over the past century from West to East.

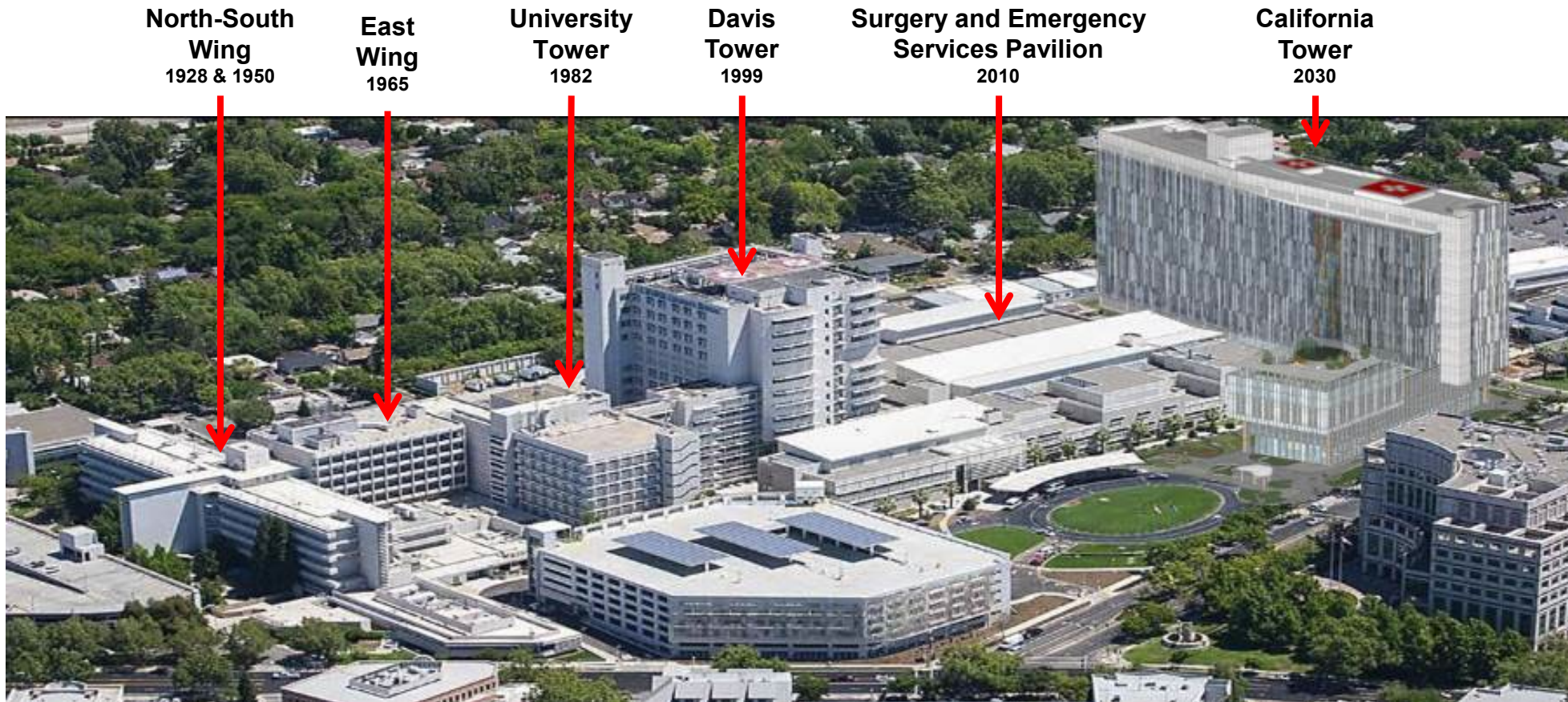

California Tower

2022 to 2030

The California Tower is a new 14 story inpatient hospital replacement tower with 351 private beds (214 Acuity Adaptable) and 12 ORs.

- 900,000 GSF
- \$3.7B Total Project Cost (\$2.4B Design + Construction)
- Anticipated First Patient: 2030



The California Tower – Make Ready Work

2022 to 2030

Advanced Work - Make Ready scope includes five (5) major phases including rerouting existing site utilities and ED access, constructing parking structure 5.

Advanced Work Phase – Main Entry

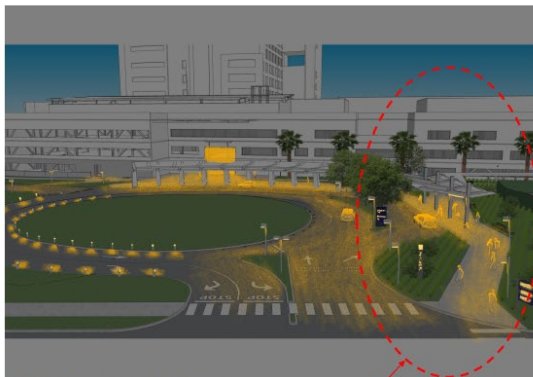

NIGHT VIEW OF MAIN ENTRY CIRCLE



Interim ED Drop-Off

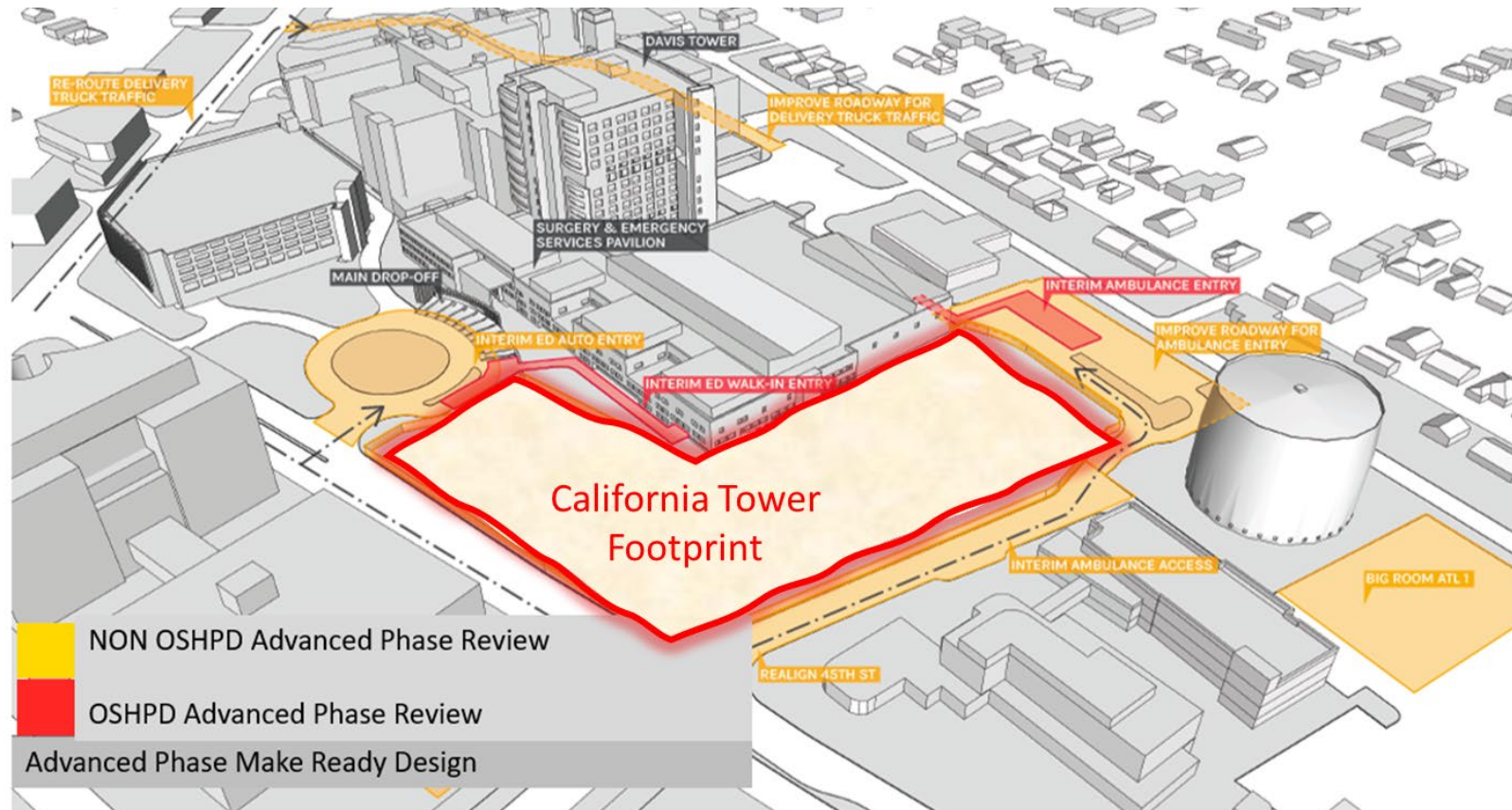

The California Tower – Make Ready Work

2022 to 2030

Advanced Work - Make Ready scope includes five (5) major phases including rerouting existing site utilities and ED access, constructing parking structure 5.

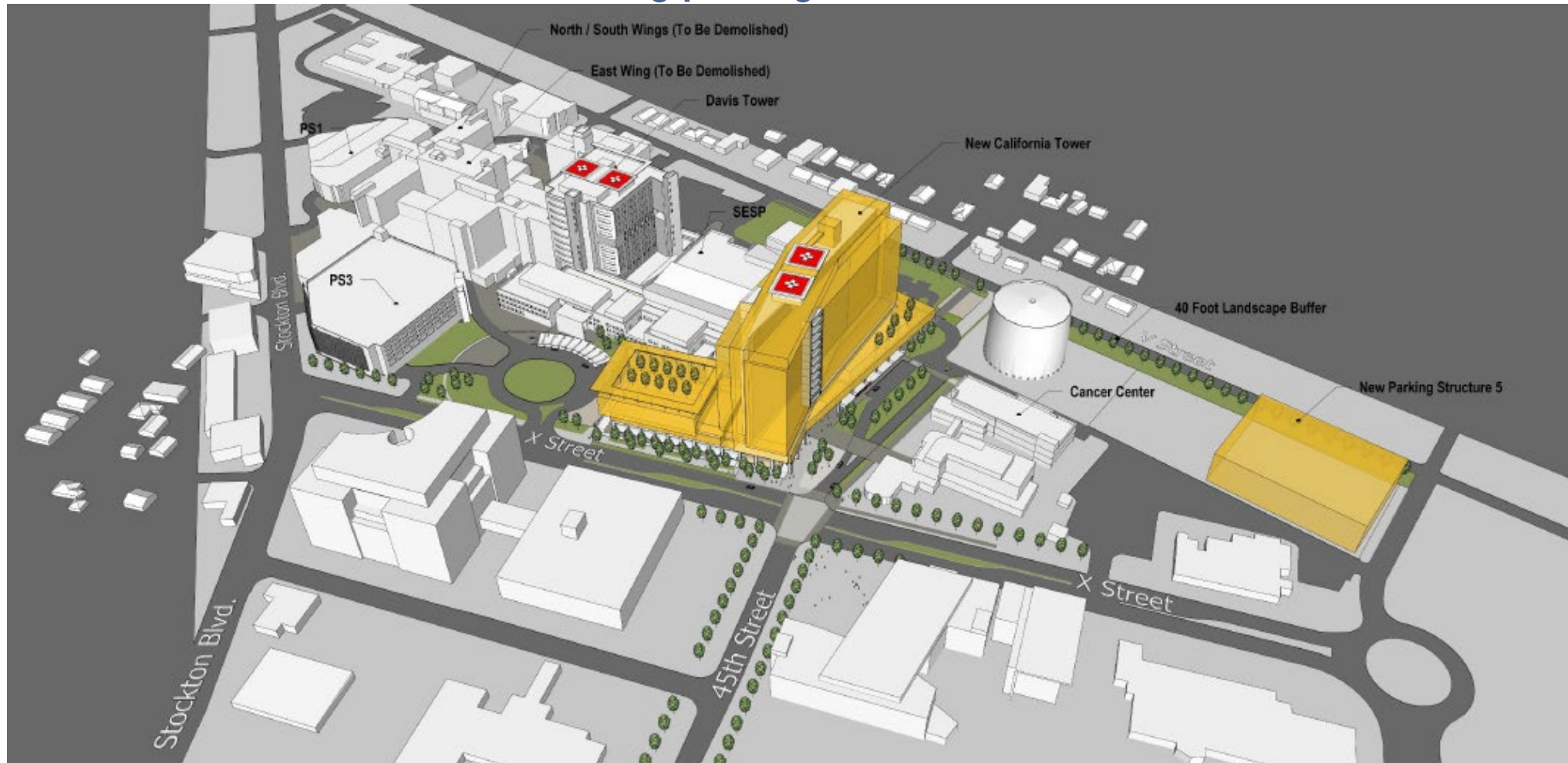

The California Tower - Rendering

2022 to 2030



The California Tower Courtyard - Rendering

2022 to 2030



North South Wing Disposition/Demolition

2022 to 2030

Current seismic mandates requires all occupants and operations to clear the structure by December 31, 2023. Several infrastructure and relocation projects underway.

- Originally constructed in late 1920's and added on to in the 1950's
- Many critical care services were relocated in mid 2000's
- Approximately 188,000 square feet / 6 stories plus basement

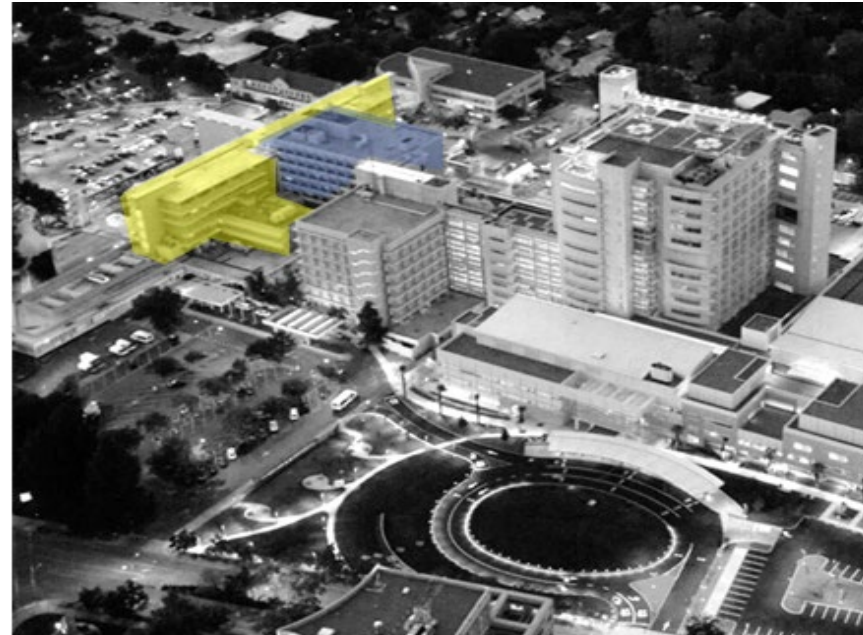

Aggie Square

2022 to 2030

The Aggie Square development will develop the 45th Street corridor connecting the South side of the campus to the Hospital zone – or North side of the campus.

- 600,000 GSF
- 1,600 stalls of parking
- Construction start - 2022
- Opening 2025



Aggie Square – Site Plan

2022 to 2030

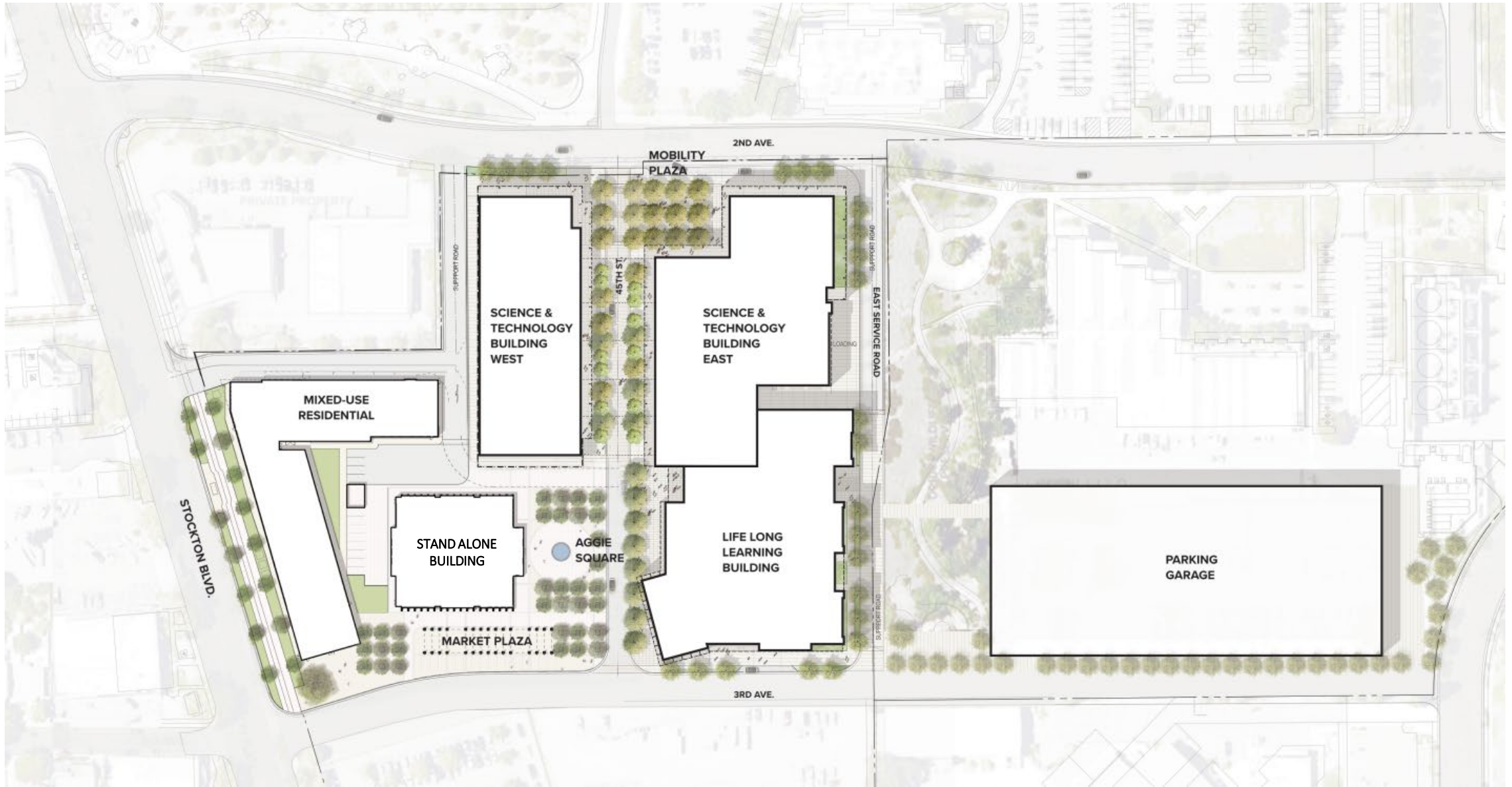

Aggie Square



Aggie Square- photos 4/13/2023



Campus Parking

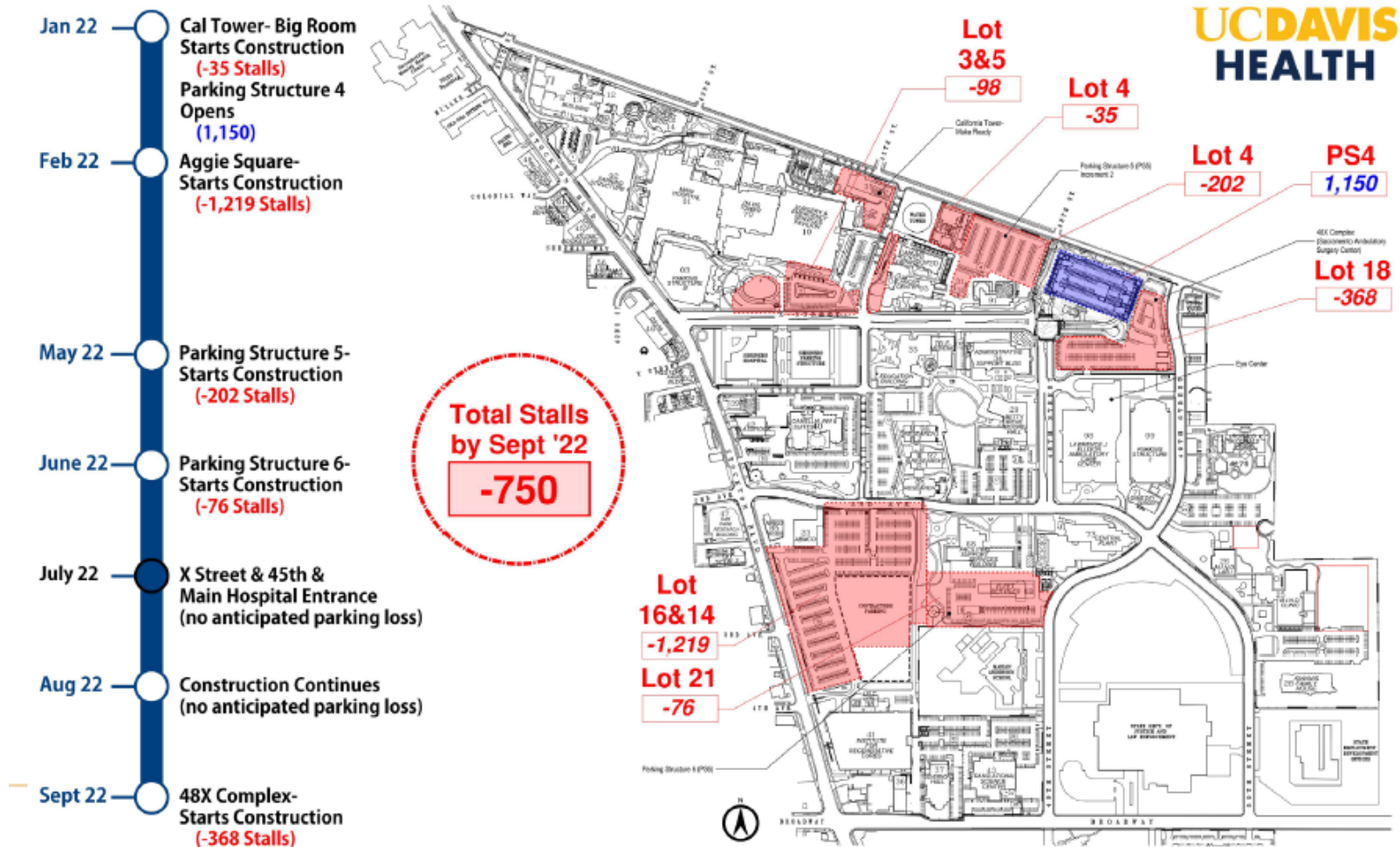

Parking Structure 5 and 7 (proposed)

2022 to 2030

Parking Structure 5 will accommodate approximately 1,000 stalls of parking. The project includes a new 20' promenade and a plaza area north of the Cancer Center.

Square Footage:
317,105

Levels:
Split 4/6

Stall Count:
957

EV Charging Spaces:
96 Day One
96 Future

Anticipated Opening:
Fall-Summer 2023



Parking Structure 7 proposal

Construction:
2023 and 2024

Opening: 2025

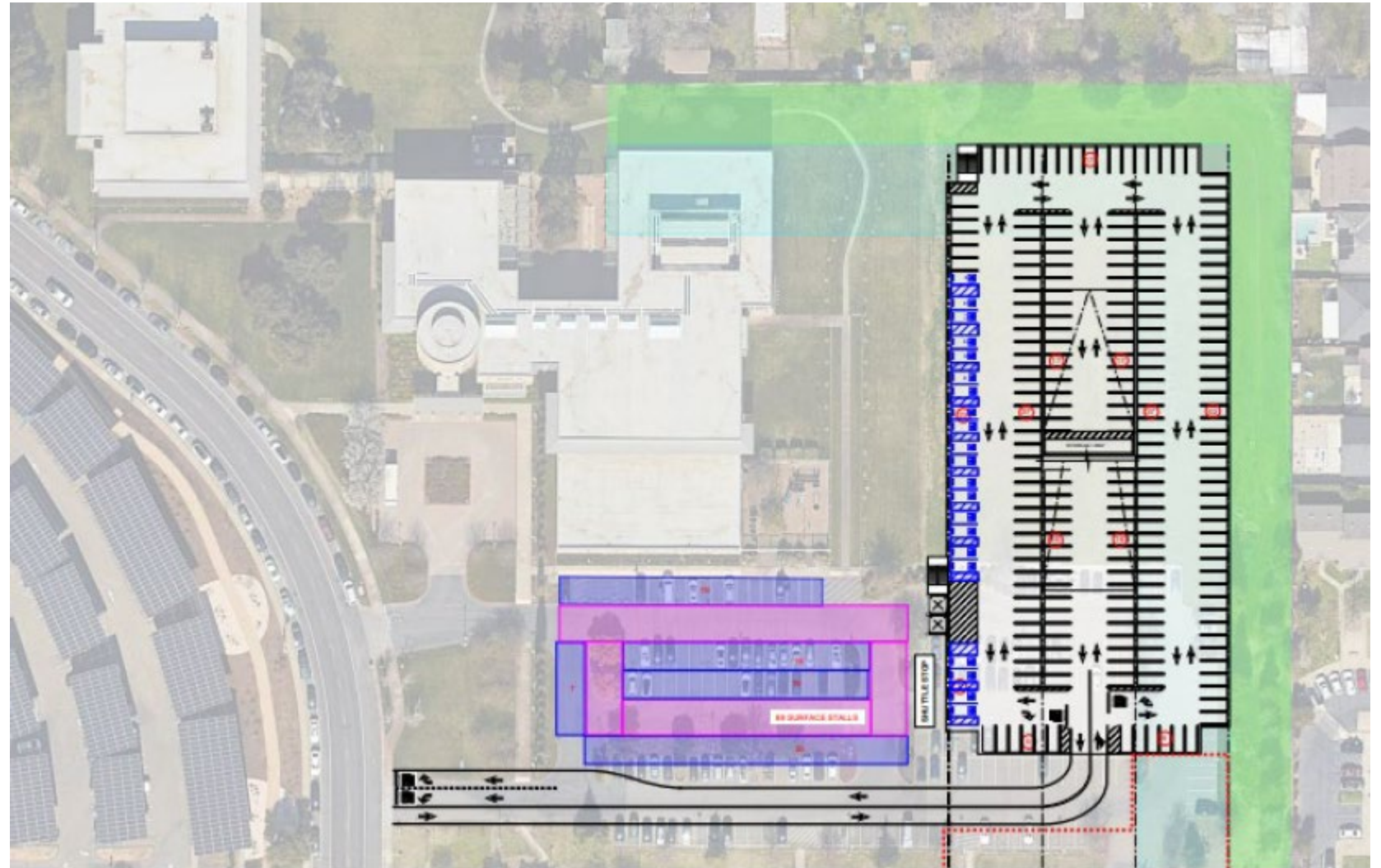

Last Photos—Stockton entrance at 3rd Avenue



Last Photos—Shuttle for State Fair



Questions?

Submit Questions using the Q&A feature on the Zoom toolbar.



Questions?

For Verbal Questions raise your hand on the Zoom toolbar.

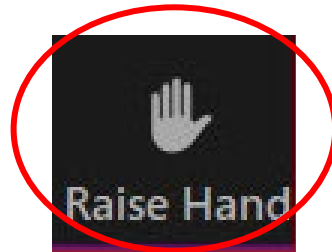

- If joining from your phone, dial *9 to raise your virtual hand
- Commenters will be called in the order of hands raised. If you lower your hand, you will lose your place in the queue
- Staff will send you a request to unmute yourself when it is your turn to speak

An aerial photograph of the University of California, Davis campus during sunset. The sky is a mix of orange, yellow, and blue. Several large, modern academic buildings with glass facades and flat roofs are visible. In the foreground, there's a parking lot with a sign that says "PARKING". The overall scene is a wide-angle shot of the university's main campus.

Thank You--Campus Open House Planning and Projects Update April 13, 2023

Hosts:

Laura Niznik Williams, Director of Government & Community Relations
Matt Dulcich, Director of Planning